

# Model S-6 & S-5 (No. 125-175) and Model H-1 & H (No. 50) Sealed Beam Safetylights and Roof Utility Light

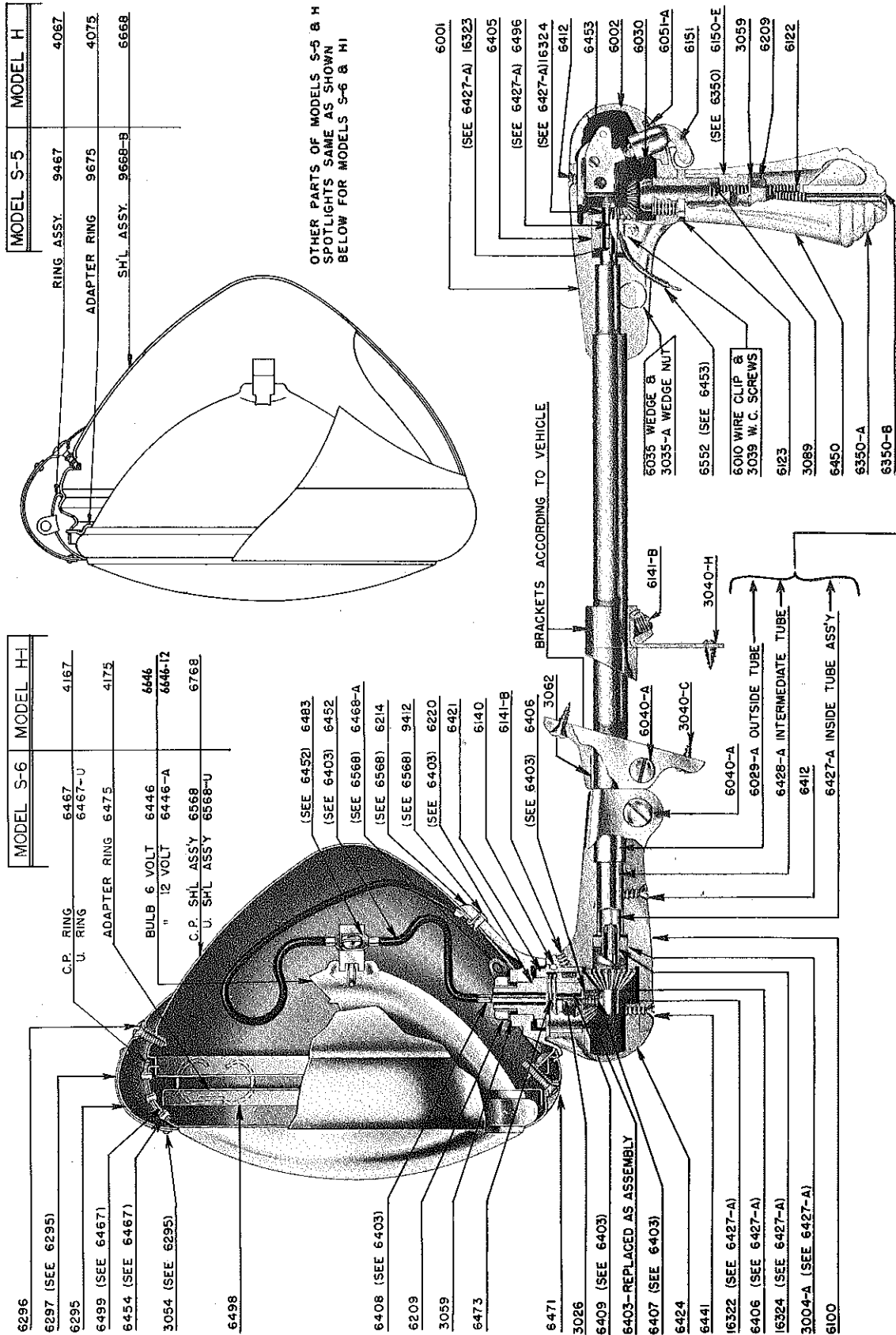

WHEN ORDERING TUBES, CHECK OVERALL LENGTH AND SPECIFY PART NUMBER ACCORDINGLY. SEE PAGE 4  
NOTE - Reflector, lens, gasket, socket, and prefocused bulb assembly same as S-4 & D-4 Models. See page 3.

1/20/54

# Stock 780 Panoramic Mirror

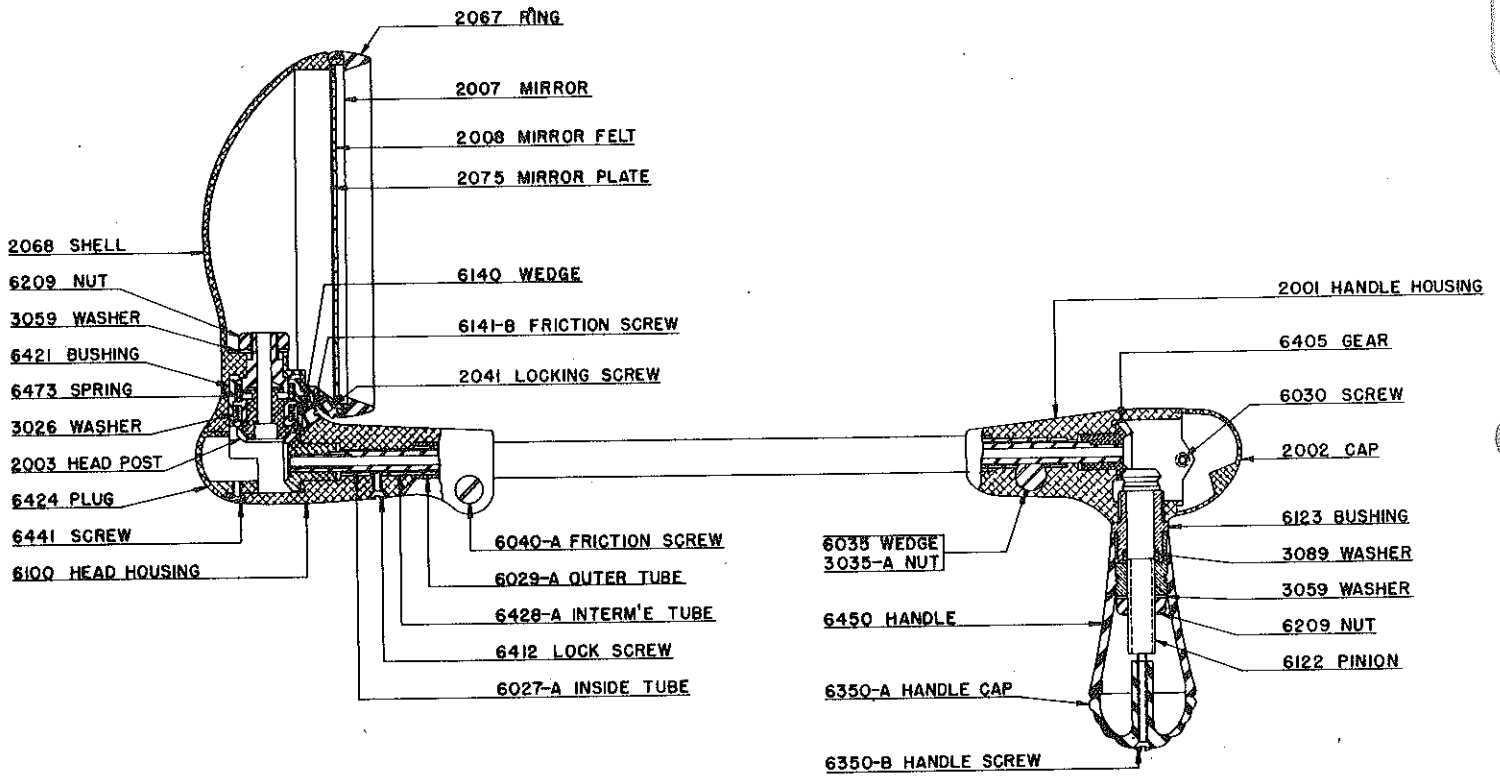

# Stock 770 Unilite-6 Volt Stock 772 Unilite-12 Volt

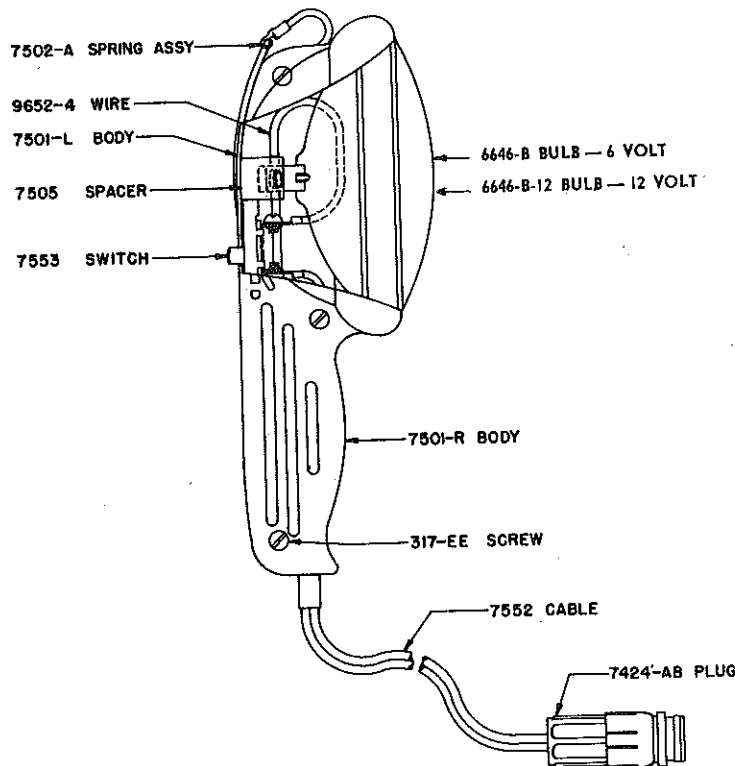

On Wholesale orders for Parts Only, totalling less than \$3.00 wholesale, a Service Charge of 25¢ will be added.

**EFFECTIVE SEPTEMBER, 1953**  
**PARTS PRICES (U.S.A.) PLEASE ORDER BY PART NUMBER**  
**PRICES SUBJECT TO CHANGE WITHOUT NOTICE**

**GASKETS**

Part No.	Description	List Price
9170	Synthetic Rubber Gasket, 7/32" x 5/32", for S3, S4, S5, D4 & D5 and Model H Safetylights, 19 1/2" long—cut to fit light.....	.23

**BULBS** Net—No Discount

Bayonet base type, Single Contact for Sportlites and S, S1, S2, D & D1 Safetylights

Part No.	Description	List Price
6046-A	6-8 Volt, 50 C.P., Bulb No. 1183...	.39
6046-C	12-16 Volt, 32 C.P., Bulb No. 1143	.40
<b>Prefocused type, single contact for S3, S4, S5 &amp; H Safetylights</b>		
6146-E	32 Volt, 50 C.P., Bulb No. 1057...	1.20
6146-G	24-28 Volt, 50 C.P.....	1.10
9146-A	6-8 Volt, 50 C.P., Bulb No. 1503...	.62
9146-C	12-16 Volt, 32 C.P., Bulb No. 1327	.77
9146-D	12-16 Volt, 50 C.P., Bulb No. 1507	.83
9646	6-8 Volt, 32 C.P., Bulb No. 1209 or 1323 .....	.60

**SEALED BEAM TYPE**

4046-R	RED 6 Volt, 25 Watt, GE #4510R for Models H & H1, & #770 UNILITE .....	\$3.45
6446	6 Volt, 30 Watt, GE #4535 for Models S3, S4, S5, S6 Safetylights & #741 & 743 Searchlights .....	2.00
6446-R-6	6 Volt, 30 Watt, GE #4535R for Models S3, S4, S5, S6 Safetylights .....	3.60
6446-A	12 Volt, 30 Watt, GE #4435 for Models S3, S4, S5, S6 Safetylights & #742 & 744 Searchlights .....	2.60
6446-R-12	12 Volt, 30 Watt, GE #4435R for Models S3, S4, S5, S6 Safetylights .....	4.20
6646	6 Volt, 30 Watt, GE #4515 for H & H1 Safetylight .....	1.95
6646-12	12 Volt, 30 Watt, GE #4405 for H & H1 Safetylight .....	2.65
6646-B	6 Volt, 30 Watt, GE #4516 for #770 UNILITE .....	1.85
6646-B-12	12 Volt, 30 Watt, GE #4416 for #772 UNILITE .....	2.15
9646-R	6 Volt, 25 Watt, GE #4013-R for Models S3, S4, S5, S6 Safetylights .....	3.25
9646-R-12	12 Volt, 35 Watt, GE #4413-R for Models S3, S4, S5, S6 Safetylights .....	3.75
9646-T	Flood type, 6 Volt, 25 Watt, GE #4013 for Models S3, S4, S5, S6 Safetylights .....	1.65
16346-24	24 Volt, 120 Watt, GE #4530 for Models S5, S6 Safetylights .....	5.00

**LENSES**

<b>Clear—Crystal</b>		
3048	Lens for Jr. Sportlite, 5 1/8" O.D.....	\$ .58
3065	Lens for Deluxe Sportlite, 6 1/4" O.D. ....	.58
4048	Lens for "H" Safetylight 4 3/8" O.D. ....	.58
6061	Lens for S, S1, 2, 3, 4, 5 Safetylights, 5 1/8" O.D. ....	.58
6065	Lens for D, D1, 4, 5 Safetylights, 6 1/4" O.D. ....	.58
<b>Clear Ruby Lenses</b>		
3061-RP	Ruby "POLICE" lens, for Std. Sportlite, 5 3/4" O.D. ....	4.00
6065-R	Ruby Lens for D, D1, 4, 5 Safetylights, 6 1/4" O.D. ....	4.00

**FIRED CERAMIC COLORED LENSES WITH WHITE LETTERING**

Part No.	Description	List Price
6061-BA	Blue Lens with "Cross" & "Ambulance"—for S, S1, 2, 3, 4, 5 Safetylights, 5 1/8" O.D. ....	2.30
6061-RP	Red Lens with "POLICE" for S, S1, 2, 3, 4, 5 Safetylights 5 1/8" O.D. ....	2.30
6061-RHP	Red Lens with "HIGHWAY PATROL", for S, S1, 2, 3, 4, 5 Safetylights, 5 1/8" O.D. ....	2.30

**FIRED CERAMIC COLORED LENSES WITH WHITE LETTERING**

6061-RS	Red Lens with "SHERIFF", for S, S1, 2, 3, 4, 5 Safetylights, 5 1/8" O.D. ....	2.30
6065-RP	Red Lens with "POLICE", for D, D1, 4, 5 Safetylights, 6 1/4" O.D. ....	2.30
6065-RS	Red Lens with "SHERIFF", for D, D1, 4, 5 Safetylights, 6 1/4" O.D. ....	2.30

When current supply of each above Clear Ruby and Fired Ceramic Lenses is exhausted, it will be discontinued and replaced by Red Sealed Beam Bulbs.

**SPOTLITE, MIRROR and UNILITE PARTS**

Part No.	Description	List Price
317-EE	Connecting Screw .....	.10
2001	Mirror Handle Casting Only .....	2.76
2002	Mirror Handle Cap .....	1.27
2003	Headpost and Gear Assy., Incl. Nos. 3020-B, 3026, 3073-A, 6220 and 6403 .....	1.15
2007	Mirror Glass .....	1.00
2008	Mirror Felt .....	.26
2041	Ring Locking Screw .....	.10
2067	Mirror Ring .....	.80
2068	Mirror Shell .....	3.25
2075	Mirror Plate .....	.70
3015	Outside Post Bracket Gasket.....	.12
3026	Felt Washer .....	.07
3039	Wire Clip Screw.....	.06
3040-C	P.K. Sheet Metal Bracket Screw.....	.07
3040-H	Sheet Metal Bracket Screw .....	.06
3059	External Tooth Lockwasher .....	.10
3062	Shaft Sleeve for Bracket.....	.14
3089	Felt Washer .....	.06
4067	Ring for Model H, incl. #9471-2..	1.38
4075	Adapter Ring .....	1.35
4167	Ring for Model H1.....	1.70
4175	Adapter Ring for Model H1.....	.70
6001	Spot Lite Handle Casting only .....	2.76
6002	Switch Cap Assembly, incl. Part Nos. 6051-A, 6151 & 2-6030.....	1.27
6010	Wire Clip .....	.06
6027-A	Inside Tube and Gear—11 1/2" overall, 5/8" O.D. tube & 18 tooth gear .....	1.38
6027-B	Inside Tube and Gear—9 3/4" overall .....	1.38
6027-P	Inside Tube and Gear—13 1/2" overall .....	1.38
6027-V	Inside Tube and Gear—12 1/2" overall .....	1.38
6029-A	Outside Tube—7 7/8" overall.....	1.27
6029-B	Outside Tube—6 1/8" overall.....	1.27
6029-P	Outside Tube—9 7/8" overall.....	1.27
6029-V	Outside Tube—8 7/8" overall.....	1.27
6030	Screw for Cap.....	.06
6035	Handle Wedge and Nut.....	.23
6040-A	Outside Bracket Clamp Screw—1 1/4" long .....	.12
6051-A	Toggle Screw only.....	.06
6100	Lamp Housing Casting .....	2.76
6122	Handle Shaft and Pinion Gear—12 teeth—tapped end .....	.81
6123	Handle Sleeve and Bushing.....	.92
6140	Wedge Pin .....	.06

## SPOTLITE, MIRROR and UNILITE PARTS

## SPOTLITE, MIRROR and UNILITE PARTS

Part No.	Description	List Price
6141-B	Vertical Friction Set Screw.....	.06
6151	Switch Toggle only .....	.41
6209	Nut for Handle & Shoulder Post..	.12
6295	Shell Ornament, complete with Unity Name Plate #6297.....	.92
6296	Shell Ornament Attaching Screw...	.07
6350-A	Lower Section of Handle.....	.35
6350-B	Handle Screw .....	.07
6403	Head Post & Gear Assy., incl. Nos. 3026, 3073A, 6220, 6403, 6406, 6407, 6408, 6409 & 6552 Wire...	1.73
6405	Gear, Handle End Inside Tube.....	.35
6412	Screw to Switch & Inter. Tube.....	.06
6421	Bushing, Head Post.....	.69
6424	Plug, Head Housing.....	.35
6427-A	Inside Tube Assy.—12" overall includes parts 3004-A, 6406, 6496, 16322, 16323 & 16324.....	1.96
6427-B	Inside Tube Assy.—10 $\frac{1}{4}$ " overall	1.96
6427-P	Inside Tube Assy.—14" overall.....	1.96
6427-V	Inside Tube Assy.—13" overall.....	1.96
6428-A	Intermediate Tube—9 $\frac{7}{8}$ " overall	.81
6428-B	Intermediate Tube—8 $\frac{1}{8}$ " overall	.81
6428-P	Intermediate Tube—11 $\frac{7}{8}$ " overall	.81
6428-V	Intermediate Tube—10 $\frac{7}{8}$ " overall	.81
6441	Screw, Plug—4-36 x $\frac{1}{8}$ " oval head	.06
6450	Upper Section Handle.....	.69
6453	Switch Assy. for S5, S6, H & H1, including #6552 wire.....	1.38
6467	Ring for Model S6.....	1.38
6467-U	S6 Ring for Utility Light.....	1.38
6471	Ring Screw .....	.06
6473	Head Post Spring.....	.14
6475	Adapter Ring for Model S-6.....	.70
6498	Lock Spring for Adapter Ring.....	.06
6552	Outside Wire .....	.40
6568	Shell Assy. for S6, including Shell Bracket & Reinforcing Plate.....	4.14
6568-U	S6 Shell Assy. for Utility Light, incl. Shell Bracket & Reinforcing Plate .....	4.14
6668	Shell Assembly, incl. shell bracket, Reinforcing Plate & Ground Wire	4.14

Part No.	Description	List Price
6768	Shell Assembly, incl. Shell Bracket & Reinforcing Plate.....	4.14
7424-AB	Unilite Plug .....	.80
7501-L	Left Body Section.....	2.00
7501-R	Right Body Section.....	2.00
7502-A	Spring Assembly .....	.45
7505	Bulb Spacer .....	.12
7552	Cable Assembly incl. 7424-AB.....	1.90
7553	Switch Assembly .....	1.25
9010-A	Safetylight Wire Grommet.....	.07
9467	Ring for Model S-4 & S-5, incl. 9471-2 .....	1.38
9471-2	Ring Screw and Nut, 8-32 x $\frac{7}{8}$ "	.14
9652-4	Wire Assembly .....	.10
9668-B	Shell Assembly, Model S-4 and S-5, including Parts Nos. 6214 and 9468-A .....	4.14
9675	Adapter Locating Ring.....	1.35
	All Brackets, except No. 100-7.....	2.25 Set
	Outside Bracket .....	1.35
	Inside Bracket .....	.90
	Bracket No. 100-7—Roof Mounting.....	4.14 Set
	Bracket Locating Fixture and Pointer.....	1.50 net
	Special $\frac{1}{2}$ " Twist Drill Bit—10" Long.....	4.90 net
	Resilvering Reflector .....	1.25 net

## SUB-ASSEMBLIES

Head Assembly, includes Shell Assembly, Adapter Ring, Glaseal Bulb, Ring & Ornament—Order by Model and Voltage.	
Model S-5, S-6, H or H-1—6 Volt.....	9.66
Model S-5 or S-6—12 Volt.....	10.16
Head Casting and Tube Assembly, includes Head Casting & three tubes—Order by overall tube length — 10 $\frac{1}{4}$ " — 12" — 13" — 14" — also whether for corner post or roof mounting light	6.80
Handle Casting & Handle Assy., includes Handle Casting, Switch, Switch Cap, Handle Gear, Shaft & Pinion Gear, Sleeve & Bushing and complete Plastic Handle; specify whether for S-3, S-4, S-5, S-6, H, H-1 Light.....	7.91

If other length tubes are desired—add \$1.00 list per foot, or part thereof, per tube and specify overall length wanted.